

Let it be examined whether this distance here called 537640 be true for according to Ellis Hughes's survey for J Lewis on a tract of 92.141 per the whole length of this tract added to 280 per the length of the adjoining tract is 310 perches. See another Draught.

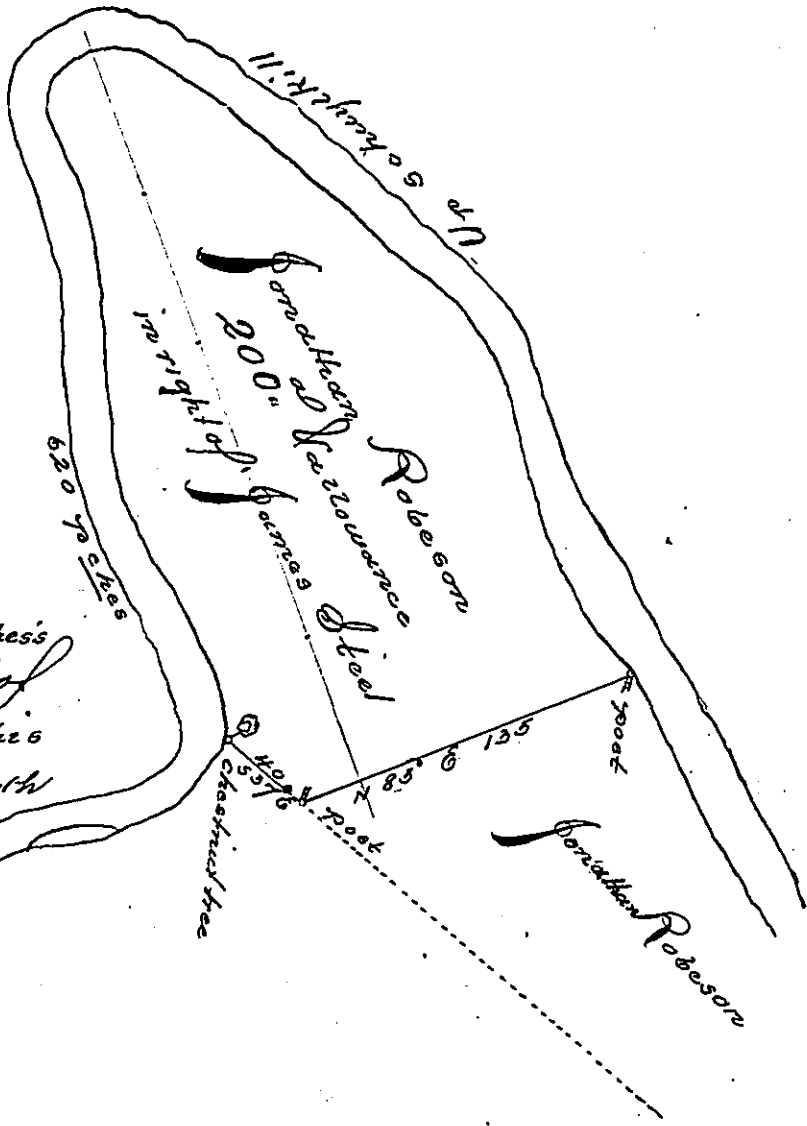

By Virtue of a Warrant from the Proprietaries dated the 26th day of March 1733. A survey to James Steel, in right of William Markham the quantity of 2400, acres, Survey'd for Jonathan Robeson the second day of April then next ensuing, the above described Tract of Land situated on the River Schuylkill in the County of Lancaster containing two hundred acres and the allowance of six sq. Perch

J. Jno Taylor

IN TESTIMONY that the above is a copy of the original remaining on file in the Department of Internal Affairs of Pennsylvania, made conformably to an Act of Assembly approved the 16th day of February, 1833, I have hereunto set my Hand and caused the Seal of said Department to be affixed at Harrisburg, this sixth day of June, 1899.

*James W. Latta*  
Secretary of Internal Affairs.